

ITEM	PART NO	QTY	MODEL / DESCRIPTION
①	(7544)	1	TCO-47(01)-E / ECU ONLY
②	-	1	TCO-47(01)-IG / INSTALLATION GUIDE (NOT SHOWN)
③	-	1	TCO-47(01)-DS / DASHBOARD STICKER (NOT SHOWN)
④	(N/A)	1	CUT-OUT SWITCH (NOT SHOWN)

Revision Notes				
R1 - MANUFACTURING LABEL DETAILS ADDED, FRAME UPDATED, KIT TABLE REVISED, NOTES REVISED, AS PER P1648				
APA: A WRIGHT	Drawn: B. STROHMER	Checked: E. MATHEW	Approved: D. FOALE	Date: 16/07/25

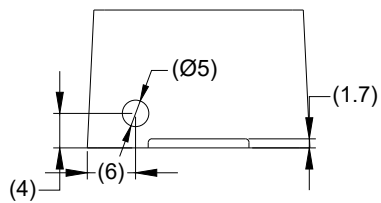
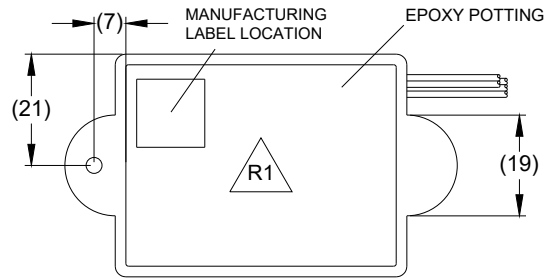
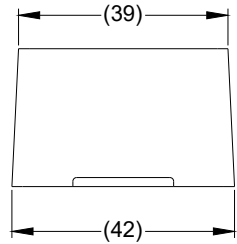
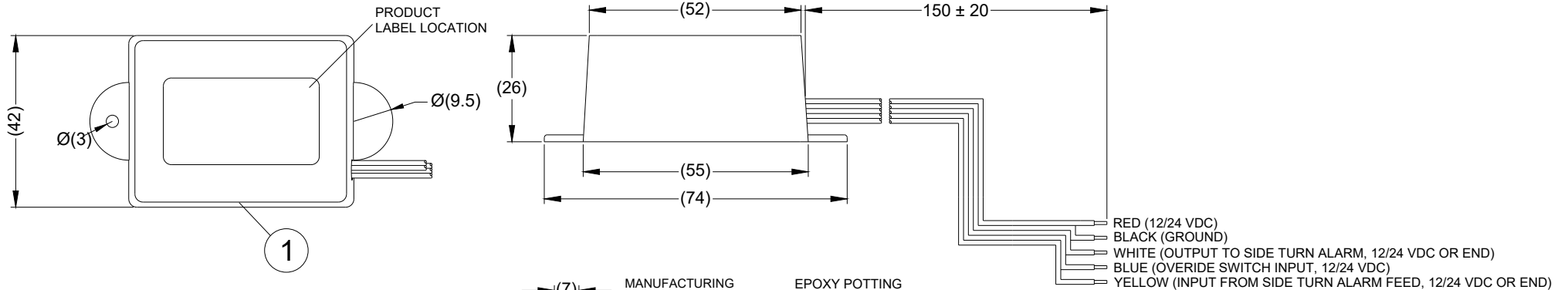

SPECIFICATION

RATED VOLTAGE: 12 AND 24 VOLTS DIRECT CURRENT (WORKING VOLTAGE RANGE 10 THRU 30 VOLTS)
 RATED CURRENT: 300 MILLIAMPERES OR LESS
 MAX CURRENT HANDLING: 10 AMPERES
 CABLE THICKNESS: POWER CABLES 16/0.2MM

OPERATION

WHEN THE CUT-OUT SWITCH IS PUSHED THE ALARM WILL SILENCE, PUSH AGAIN THE ALARM WILL SOUND.
 WHEN POWER IS CYCLED UNIT WILL RESET AND ALARM WILL SOUND.

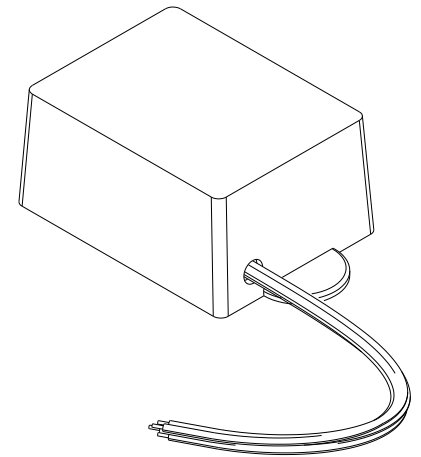

NOTES:

- DIMENSIONS IN MM
- POTTING SHOULD FULLY ENCAPSULATE THE PCB ALTHOUGH THE RELAY CAN PROTRUDE
- HOLE LOCATIONS ON THE HOUSING ARE THE RESPONSIBILITY OF THE ASSEMBLY PLANT AND SHOULD ADHERE TO DRAWING "GPL2-DRILL ISSUE 1"
- FOR LABEL AND PACKAGING DETAILS REFER TO MASTER BOM.
- ANY CUSTOMER MODIFICATION OF THIS PRODUCT CAUSING SUBSEQUENT FAILURE IS NOT A LIABILITY OF BRIGADE ELECTRONICS PLC.

PROPRIETARY NOTICE

THIS DESIGN AND TECHNICAL INFORMATION APPEARING ON THIS DRAWING IS THE PROPERTY OF BRIGADE ELECTRONICS, AND IS DISCLOSED IN CONFIDENCE. IT IS NOT TO BE COPIED, REPRODUCED, REVEALED TO OR EXPROPRIATED BY OTHERS, EITHER IN WHOLE OR IN PART WITHOUT THE EXPRESS WRITTEN CONSENT OF BRIGADE ELECTRONICS.

Brigade
brigade-electronics.com

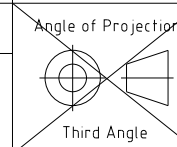

Sheet 1 of 1	Assembly Pl Approval A HEEDLE 26/09/14	Approved by B.CHILDS	Checked by R.BATES	Drawn by P.MISSEN
Customer Approval -	Angle of Projection Third Angle	Units mm	Scale N/A	Released 01/10/14
		Status RELEASED	TCO-47(01)	
		Part No 4752	BE-002989-01-14	